

# **A66 Northern Trans-Pennine Project**

**Scheme 07: Bowes Bypass**

**TR010062**

## **5.19 Rights of Way and Access Plans**

**APFP Regulations 5(2)(k) and 5(2)(o)**

**Planning Act 2008**

**Infrastructure Planning (Applications: Prescribed Forms and  
Procedure) Regulations 2009**

**June 2022**

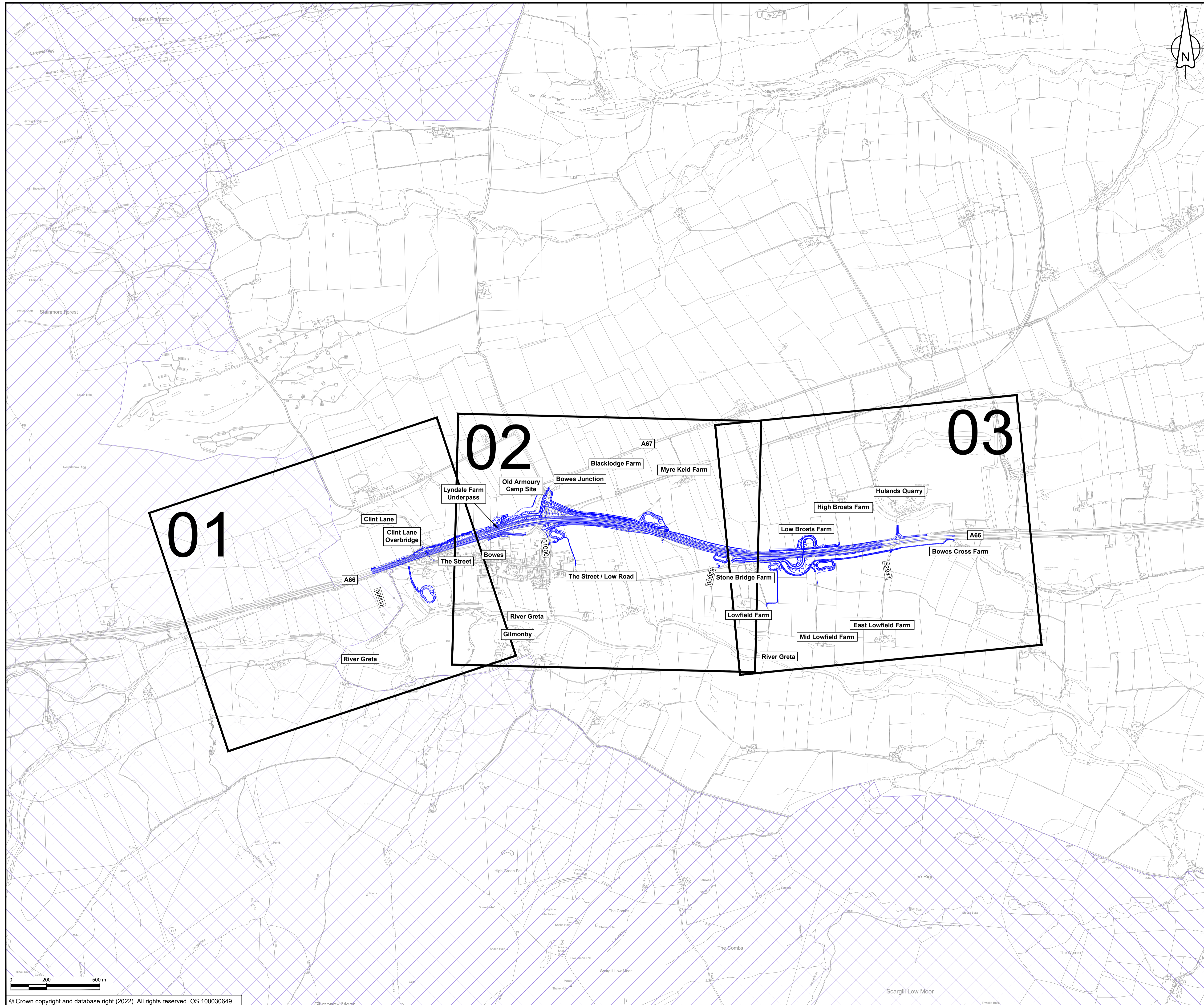

- NOTES**
- ALL DIMENSION ARE IN METRES UNLESS NOTED OTHERWISE.
- KEY**
- THE SCHEME (SHOWN FOR ILLUSTRATIVE PURPOSES ONLY)
  - SHEET USED AS PART OF THIS DRAWING SERIES
  - AREA OF OUTSTANDING NATURAL BEAUTY (AONB)
  - CHAINAGE (MEASURED DISTANCE ALONG THE SCHEME LENGTH)



C01	For DCO Submission				
	RKIG	RKIG	JBEN	THAL	SSCO
	08/06/22	08/06/22	08/06/22	08/06/22	08/06/22
Revision	Revision details				
	Created	Checked	Reviewed	Approved	Authorised
	dd/mm/yy	dd/mm/yy	dd/mm/yy	dd/mm/yy	dd/mm/yy

Purpose	DCO APPLICATION
PINS Reference Number	TR010062/APP/5.19

Client  
 3 Piccadilly Place  
 Manchester  
 M1 3BN



Project Name / Scheme Name  
**A66 Northern Trans-Pennine Project  
 Scheme 07  
 Bowes Bypass**

Drawing Title  
**Rights of Way and Access Plans  
 Regulation 5(2)(k)  
 Key Plan**

Project Ref. No.	Stage	Scale :	@ A1
---	PCF3	1:10000	
		Dimensions :	M

Drawing Number	Project	Originator	Volume
HE565627	- AMY	- HAC	-
S07	-DR-CH-	501400	
Location	Type	Role	Number

Suitability	Suitability Description	Revision
A	Approved for Stage Complete	C01



- ### NOTES
- ALL DIMENSIONS ARE IN METRES UNLESS NOTED OTHERWISE. THESE PLANS ARE TO BE READ IN CONJUNCTION WITH THE SCHEDULE ENTITLED "PERMANENT STOPPING UP OF HIGHWAYS AND PRIVATE MEANS OF ACCESS" TO THE DEVELOPMENT CONSENT ORDER.
- ### KEY
- THE SCHEME (SHOWN FOR ILLUSTRATIVE PURPOSES ONLY)
  - EXISTING HIGHWAY TO BE STOPPED UP
  - NEW OR IMPROVED HIGHWAY - TRUNK ROAD
  - NEW PUBLIC RIGHT OF WAY AND NEW PRIVATE MEANS OF ACCESS
  - NEW PUBLIC RIGHT OF WAY
  - NEW PRIVATE MEANS OF ACCESS
  - NEW OR IMPROVED SIDE ROAD
  - PRIVATE MEANS OF ACCESS TO BE STOPPED UP
  - PROPOSED SIDE ROAD / NEW PUBLIC RIGHT OF WAY BOUNDARY
  - PROPOSED TRUNK ROAD BOUNDARY
  - EXISTING PUBLIC RIGHT OF WAY
  - PARISH BOUNDARY
  - PRIVATE MEANS OF ACCESS TO BE STOPPED UP REFERENCE LABEL
  - NEW PRIVATE MEANS OF ACCESS REFERENCE LABEL
  - NEW PUBLIC RIGHT OF WAY AND SIDE ROADS REFERENCE LABEL
  - NEW WALKING AND/OR CYCLING AND/OR HORSE RIDING PROVISION (AS SPECIFIED ON PLAN AND IN SCHEDULE)
  - CHAINAGE (MEASURED DISTANCE ALONG THE SCHEME LENGTH)

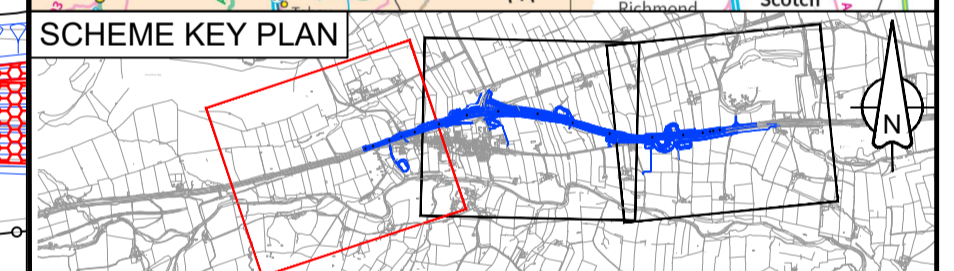
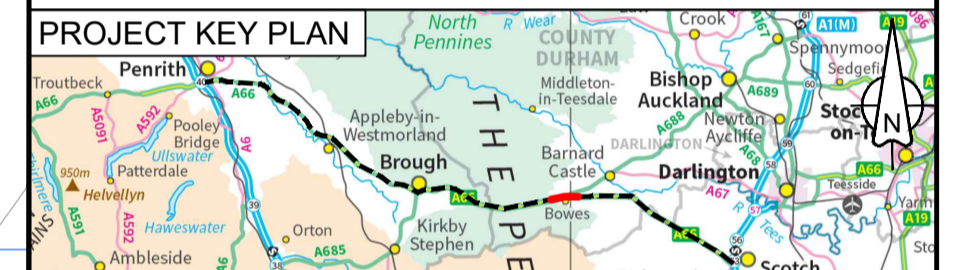

C01	For DCO Submission				
	RKIG	RKIG	JBEN	THAL	SSCO
	08/06/22	08/06/22	08/06/22	08/06/22	08/06/22
Revision	Revision details				
	Created	Checked	Reviewed	Approved	Authorised
	dd/mm/yy	dd/mm/yy	dd/mm/yy	dd/mm/yy	dd/mm/yy

Purpose: **DCO APPLICATION**

PINS Reference Number: **TR010062/APP/5.19**

Client: **3 Piccadilly Place  
Manchester  
M1 3BN**



Project Name / Scheme Name: **A66 Northern Trans-Pennine Project  
Scheme 07  
Bowes Bypass**

Drawing Title: **Rights of Way and Access Plans  
Regulation 5(2)(k)  
Sheet 1 of 3**

Project Ref. No.	Stage	Scale:	@ A1
---	PCF3	1:2500	
		Dimensions:	M

Drawing Number	Project	Originator	Volume
HE565627 - AMY - HAC -			
S07	-DR-CH-	501401	
Location	Type	Role	Number

Suitability	Suitability Description	Revision
A	Approved for Stage Complete	C01

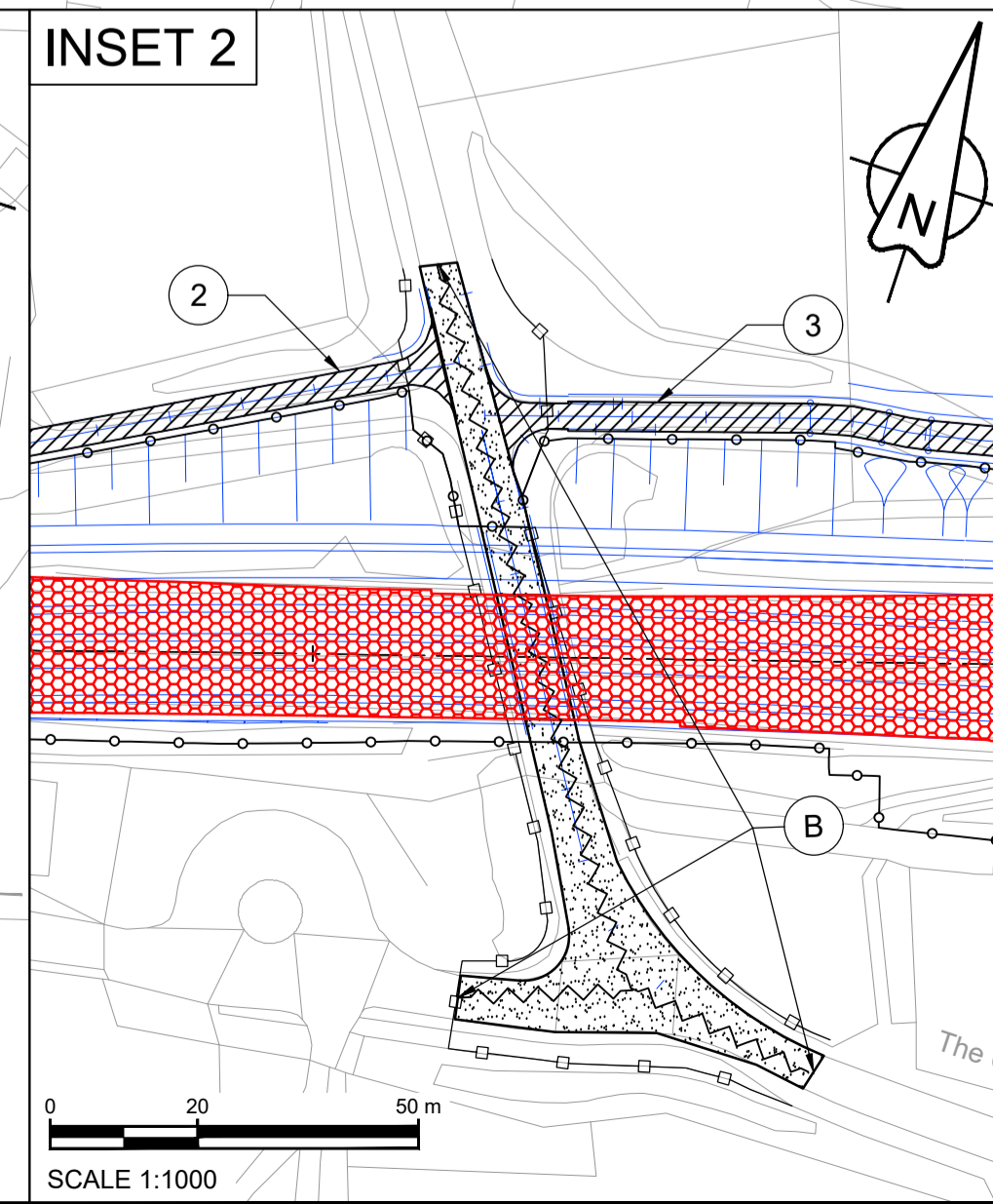
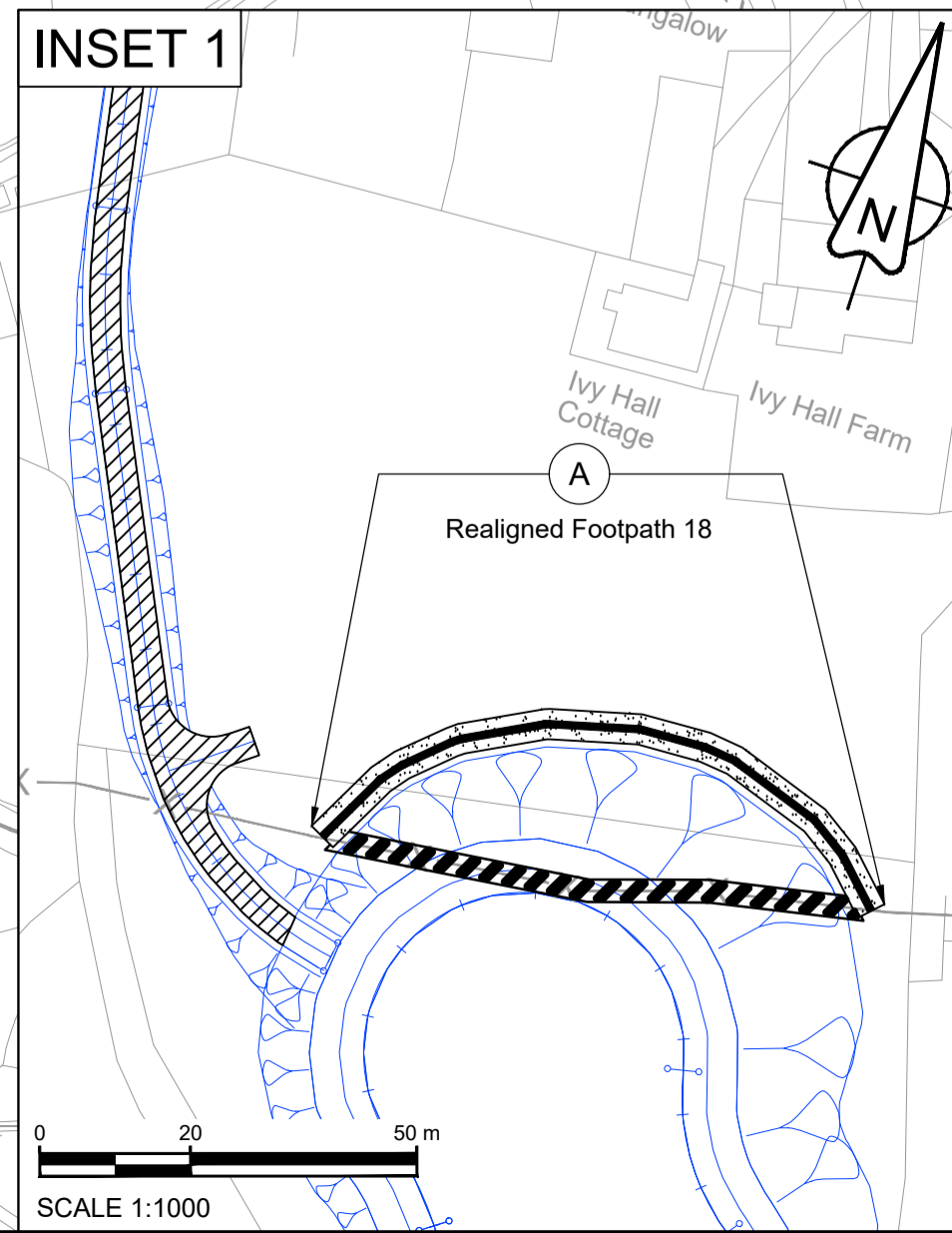

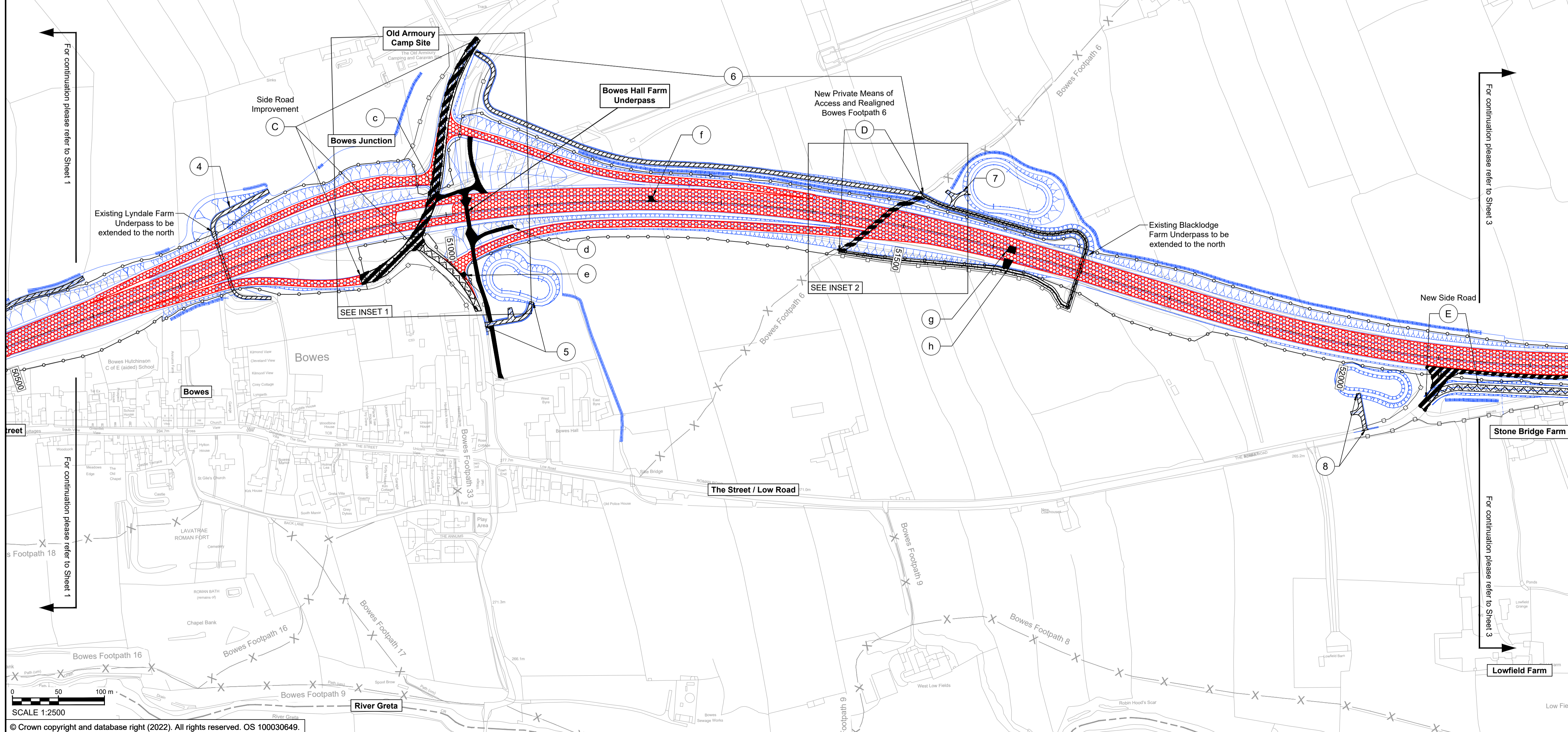
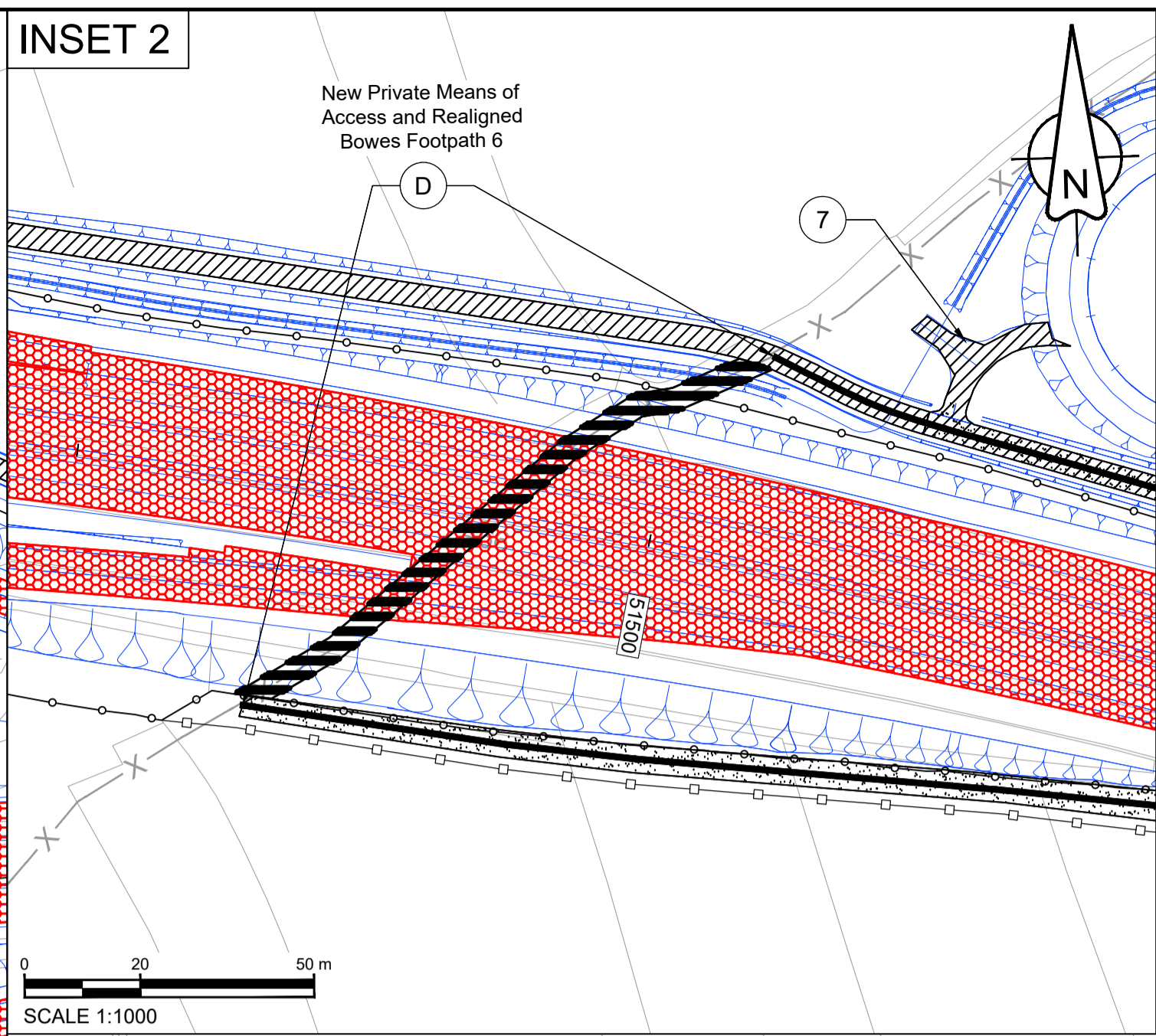
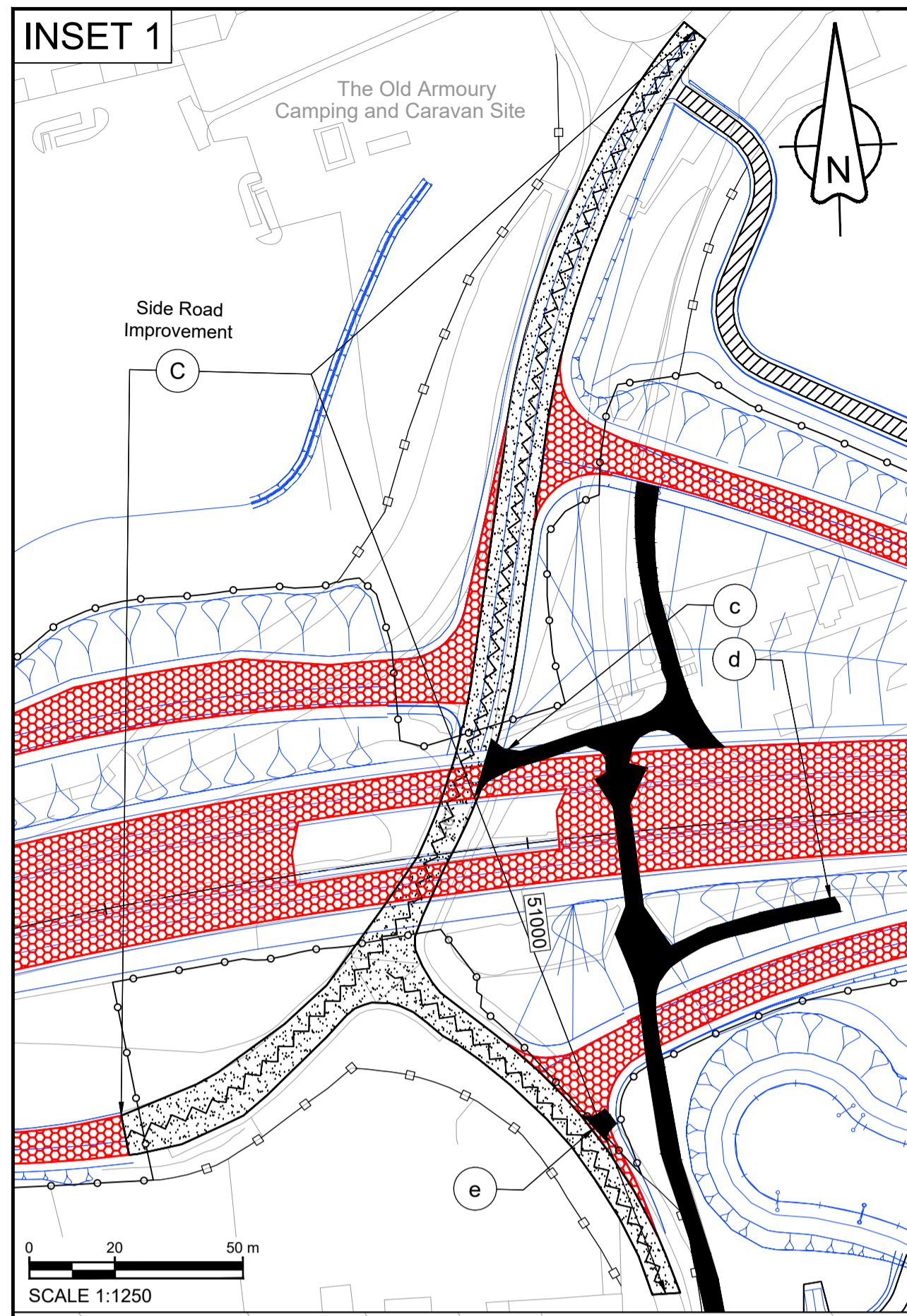

- NOTES**  
ALL DIMENSIONS ARE IN METRES UNLESS NOTED OTHERWISE. THESE PLANS ARE TO BE READ IN CONJUNCTION WITH THE SCHEDULE ENTITLED "PERMANENT STOPPING UP OF HIGHWAYS AND PRIVATE MEANS OF ACCESS" TO THE DEVELOPMENT CONSENT ORDER.
- KEY**
- THE SCHEME (SHOWN FOR ILLUSTRATIVE PURPOSES ONLY)
  - EXISTING HIGHWAY TO BE STOPPED UP
  - NEW OR IMPROVED HIGHWAY - TRUNK ROAD
  - NEW PUBLIC RIGHT OF WAY AND NEW PRIVATE MEANS OF ACCESS
  - NEW PUBLIC RIGHT OF WAY
  - NEW PRIVATE MEANS OF ACCESS
  - NEW OR IMPROVED SIDE ROAD
  - PRIVATE MEANS OF ACCESS TO BE STOPPED UP
  - PROPOSED SIDE ROAD / NEW PUBLIC RIGHT OF WAY BOUNDARY
  - PROPOSED TRUNK ROAD BOUNDARY
  - EXISTING PUBLIC RIGHT OF WAY
  - PARISH BOUNDARY
  - PRIVATE MEANS OF ACCESS TO BE STOPPED UP REFERENCE LABEL
  - NEW PRIVATE MEANS OF ACCESS REFERENCE LABEL
  - NEW PUBLIC RIGHT OF WAY AND SIDE ROADS REFERENCE LABEL
  - NEW WALKING AND/OR CYCLING AND/OR HORSE RIDING PROVISION (AS SPECIFIED ON PLAN AND IN SCHEDULE)
  - CHAINAGE (MEASURED DISTANCE ALONG THE SCHEME LENGTH)

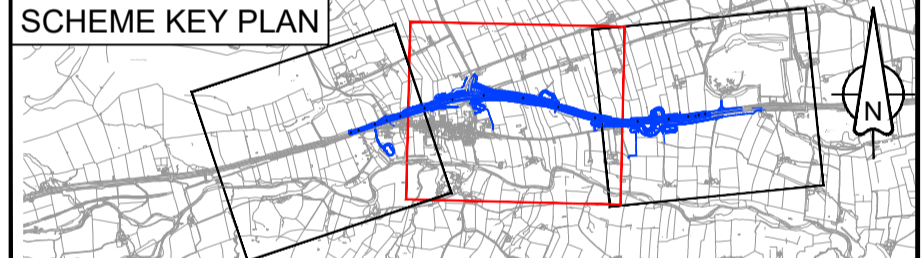
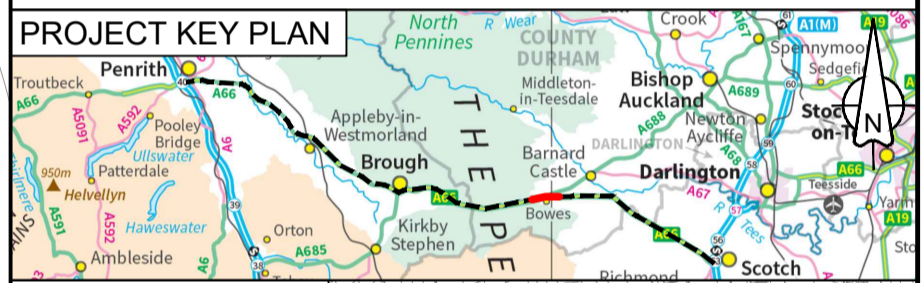

C01	For DCO Submission	RKIG	RKIG	JBEN	THAL	SSCO
		08/06/22	08/06/22	08/06/22	08/06/22	08/06/22

Revision	Created	Checked	Reviewed	Approved	Authorised
	dd/mm/yy	dd/mm/yy	dd/mm/yy	dd/mm/yy	dd/mm/yy

Purpose: DCO APPLICATION

PINS Reference Number: TR010062/APP/5.19

Client: 3 Piccadilly Place, Manchester, M1 3BN

Project Name / Scheme Name: A66 Northern Trans-Pennine Project Scheme 07 Boves Bypass

Drawing Title: Rights of Way and Access Plans Regulation 5(2)(k) Sheet 2 of 3

Project Ref. No.	Stage	Scale	@ A1
---	PCF3	1:2500	
		Dimensions	M

Drawing Number	Project	Originator	Volume
HE565627	- AMY	- HAC	-
S07	-DR-CH-	501402	
Location	Type	Role	Number

Suitability	Suitability Description	Revision
A	Approved for Stage Complete	C01

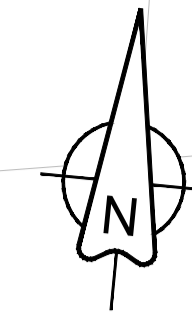
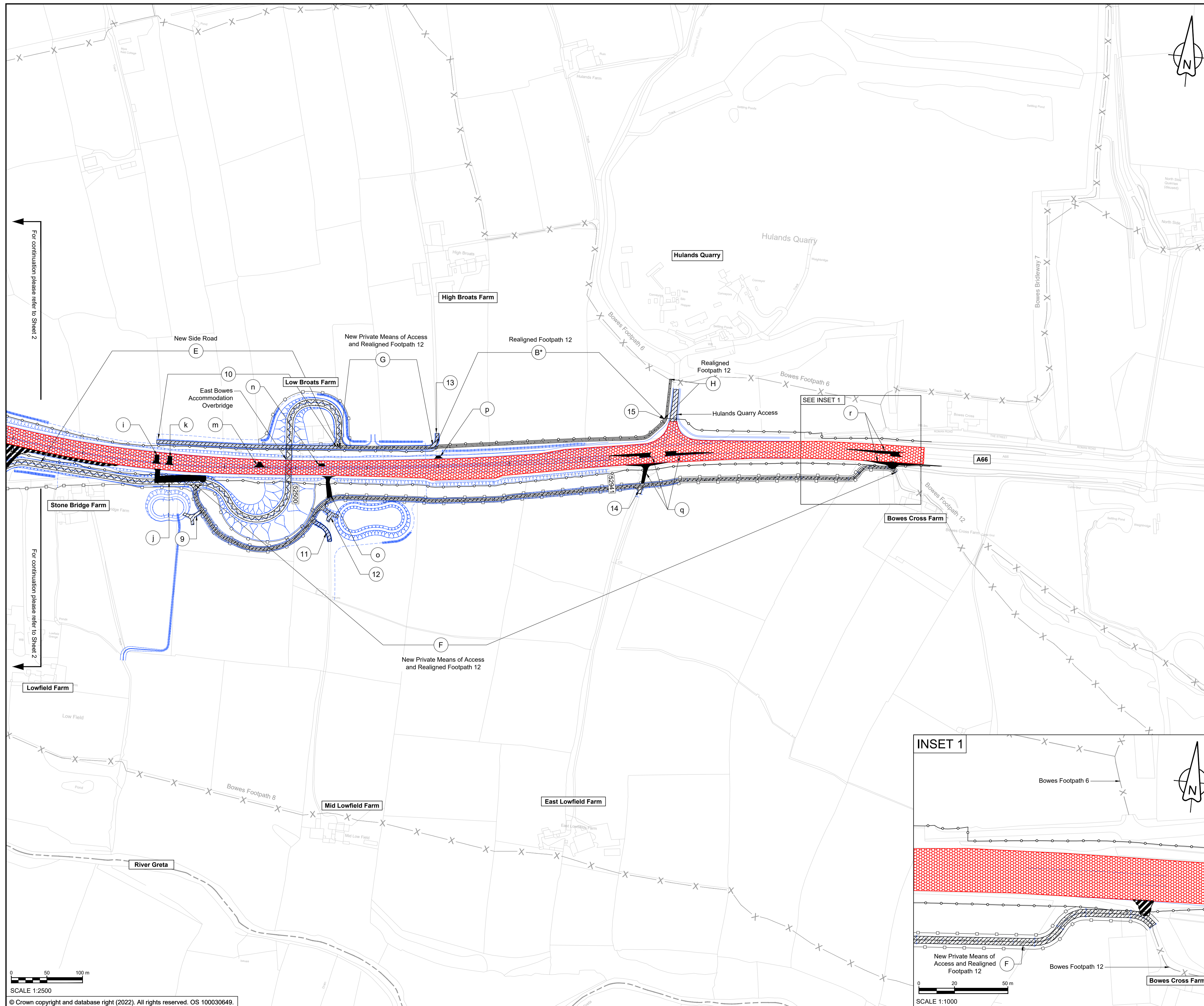

- NOTES**  
 ALL DIMENSIONS ARE IN METRES UNLESS NOTED OTHERWISE. THESE PLANS ARE TO BE READ IN CONJUNCTION WITH THE SCHEDULE ENTITLED "PERMANENT STOPPING UP OF HIGHWAYS AND PRIVATE MEANS OF ACCESS" TO THE DEVELOPMENT CONSENT ORDER.
- KEY**
- THE SCHEME (SHOWN FOR ILLUSTRATIVE PURPOSES ONLY)
  - EXISTING HIGHWAY TO BE STOPPED UP
  - NEW OR IMPROVED HIGHWAY - TRUNK ROAD
  - NEW PUBLIC RIGHT OF WAY AND NEW PRIVATE MEANS OF ACCESS
  - NEW PUBLIC RIGHT OF WAY
  - NEW PRIVATE MEANS OF ACCESS
  - NEW OR IMPROVED SIDE ROAD
  - PRIVATE MEANS OF ACCESS TO BE STOPPED UP
  - PROPOSED SIDE ROAD / NEW PUBLIC RIGHT OF WAY BOUNDARY
  - PROPOSED TRUNK ROAD BOUNDARY
  - EXISTING PUBLIC RIGHT OF WAY
  - PARISH BOUNDARY
  - PRIVATE MEANS OF ACCESS TO BE STOPPED UP REFERENCE LABEL
  - NEW PRIVATE MEANS OF ACCESS REFERENCE LABEL
  - NEW PUBLIC RIGHT OF WAY AND SIDE ROADS REFERENCE LABEL
  - NEW WALKING AND/OR CYCLING AND/OR HORSE RIDING PROVISION (AS SPECIFIED ON PLAN AND IN SCHEDULE)
  - CHAINAGE (MEASURED DISTANCE ALONG THE SCHEME LENGTH)

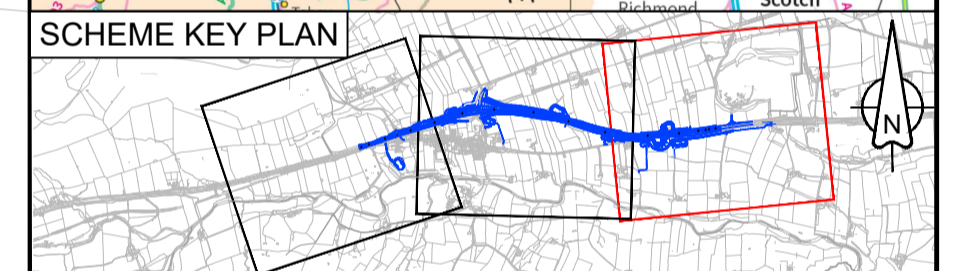
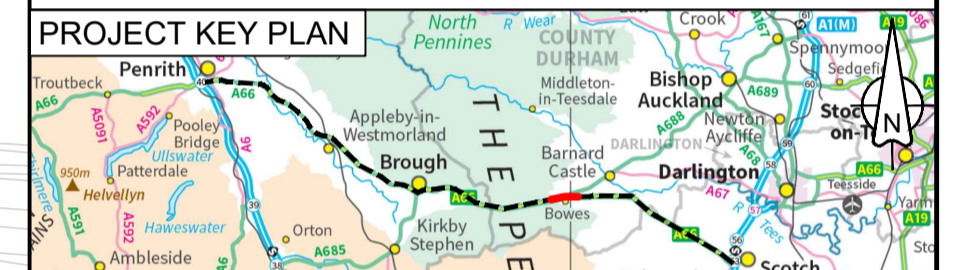

C01	For DCO Submission				
	RKIG	RKIG	JBEN	THAL	SSCO
	08/06/22	08/06/22	08/06/22	08/06/22	08/06/22
Revision	Revision details				
	Created	Checked	Reviewed	Approved	Authorised
	dd/mm/yy	dd/mm/yy	dd/mm/yy	dd/mm/yy	dd/mm/yy

Purpose: DCO APPLICATION

PINS Reference Number: TR010062/APP/5.19

Client: 3 Piccadilly Place, Manchester, M1 3BN

Project Name / Scheme Name: A66 Northern Trans-Pennine Project Scheme 07 Bowes Bypass

Drawing Title: Rights of Way and Access Plans Regulation 5(2)(k) Sheet 3 of 3

Project Ref. No.	Stage	Scale	@ A1
---	PCF3	1:2500	
		Dimensions	M

Drawing Number	Project	Originator	Volume
HE565627 - AMY - HAC -			
S07	-DR-CH-	501403	
Location	Type	Role	Number

Suitability	Suitability Description	Revision
A	Approved for Stage Complete	C01

